

Sponsors for show:

Articulate Framing Ipswich
Australian National Q.P. Society
Pony Promotion Group
Australian National Saddle Horse
Beekeepers Society Ipswich
Best Friends Pets West Ipswich
Blue Heeler Products
Bottle Tree Hotel
Bunnings Plainland and Ipswich
Dilutes Australia Ltd.
Elders Rural Service
Excellence Academy – Horses
Expert Energy Co.
Farmcraft Lowood
Fast Work Supplement Marburg
Fleet Tyres Lowood
Gavs Glass Fernvale
Stock Health Products Australia
Heritage City Photos Riverlink
Heritage Photographics Ipswich
Hilltop Farm Equestrian
Independent Pinto Horse Society
Jenny from LP Equestrian/Aussie
Jim Madden MP Ipswich West
Lowood Mowers
Mitre 10 Fernvale
Priebbenow Silage
Scottys Livestock Transport
Sprengers Rural Traders
Standardbred Association Qld.
Steinhardt Pastoral (Elwyn Steinhardt)
Steinys Earthmoving
The Commonwealth Clydesdale Horse Soc.
Toft Pastoral (Michael Toft)
Trevallan Lifestyle Centre Brassall
Tuffys Unbreakable Tubs
Wailairie Dairy goats (Est 1992)
Remi Stud.
Belford Family
B and S Dance
Eileen Steinhardt
Janet & Robert Krause
Maxine Murphy
Heather Lehmann
Geoff Beattie

Contacts:

President - Don Noble – 0417 645 127
Secretary/Treasurer - Sue Kunde - 0409 481 681
First aid – Peter – 0432 823 133 or 0412 453 096

MULTI DRAW - RAFFLE PRIZES:

3 TICKETS FOR \$5.00

Winner notified if not at draw:

1st Prize: Voucher to value of \$400.00, for Weekend for 2 people at BELAIRE PLACE, 34 Minchinton Street at Caloundra.

2nd Prize: 2 Vouchers to Meercats
Donated by Darling Downs Zoo.

3rd Prize: Adult Entry ticket to Zoo.
Donated by Australia Zoo

4th Prize: Farm Tour & Taste Voucher for 2 Adults Children. **Donated by** Summerland Camels

5th Prize: Lions Singlet (2XL) & Long Sleeve Jersey (M). **Donated by** Brisbane Lions AFL.

6th Prize: \$50 Voucher. Harmer Meats

7th Prize: \$50 Voucher. Harmer Meats

8th Prize: \$50 Voucher. Harmer Meats

9th Prize: \$50 Voucher. Harmer Meats

10th Prize: \$50 Voucher. Harmer Meats

11th Prize: \$50 Voucher. Harmer Meats

12th Prize: \$50 Voucher. Harmer Meats

Sponsors for Show:

Barbara, Geoff, Ann-Marie, Tony Frohloff
Carol Samways
Nan Sprenger
Mervyn Steinhardt
P. Frampton
P and C Lobwein
RP and L Kerwitz/S Humphries
Sue Kunde

Thank-you to everyone for their sponsorship. Thank-you to everyone who attended to make the Marburg Show a Success.



Marburg Show

13th May 2023

Official Opening by Russell Milligan

Schedule:

Judging - Stud Beef **A2**, Sheep **A1**, Donkeys **A3**, Poultry **A5**,

Dairy Goats **A4**, Miniature Goats **A6**, Horse Events **A7**

9.30am to 4.30pm - Animal Farm **D7**

10.00am – Dairy Goats – Milking Display **A4**

10.00am – Best Dressed & Fancy Dress Competition **D6**

10.00am to 3.00pm - Oceanic Display **D4**

10.00am to 3.00pm - Face Painting **D3**

10.00am to 6.00pm – Land Train. ★

Dodgem Cars, Jumping Castle & Cannibal Pots. **D1**

Shooting Gallery, Laughing Clowns & Catching a Duck **D2**

9D Virtual Reality Simulator **D9**

10.30am – Professor Wallace **D5**

11.00am - Balloon Twisting (Moving around grounds)

11.30am - Professor Wallace Puppets **D5**

12.00pm - Pet Parade **D6**

12.30pm – Andalusian display **D8**

12:30pm – Circus play space **D5**

12.30pm – Amberley Pipe Band (Moving around grounds)

1.00pm - Official Opening of Show **D8**

1.15pm - Grand Parade & Amberley Pipe Band **D8**

1.30pm - Professor Wallace **D5**

2.00pm - Light Horse **D8**

2.00pm - Giant bubbles (Moving around grounds)

2.30pm - Lester Knopke **E3**

2.30pm – Marburg Pacing & Mini Trotters **D8**

3.30pm – Display by Lockyer Valley Dance Centre **D6**

3:30pm - Stilt walking while spinning a hoop.

4.00pm - Professor Wallace Puppets **D5**

6.00pm - Billy Bridge Entertainer **E3**

7.00pm - Fire Works **A7**

10.00pm - Close

Gold Sponsors:



Barbs Kitchen Minden
Barbs Kitchen Fernvale.
Keiths Farming Solutions,
Ray White Ipswich,
Heartwood Tree Solutions,
The Lockyer & Somerset
Independent.

Silver Sponsors:

SEQ Aerial Agriculture,
Fusion Financial Services,
Malabar Red Brahams,
Rosewood Vet Surgery,
Harmer Family Meats

Bronze Sponsors:

Shayne Neumann MP Blair,
Jim McDonald MP Lockyer,
M and M Roses,
Porters Plainland,
Elders Rural Services,
Spars Marburg,
Hayes and Co.,
Moreton Saleyards,
Sort it out Water Treatment,
Strasburg Brothers Transport,
Imbibus Craft Distillery,
Boughen Bitumen.

Paper supplied and printed by
Shayne Neumann. Federal
Member for Blair.

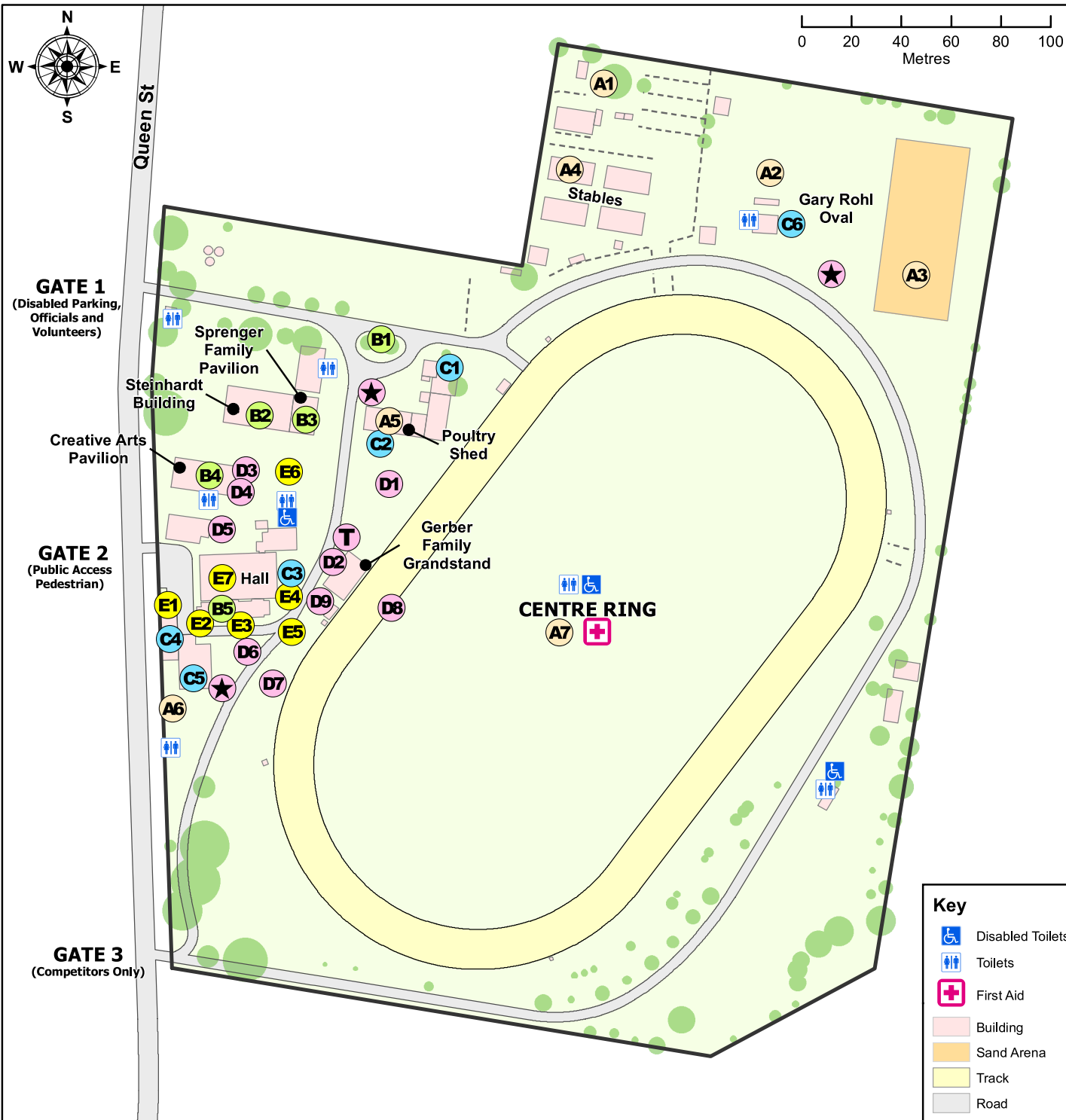

Marburg Show 2023

Animals

- A1** Sheep
- A2** Stud Beef
- A3** Donkeys
- A4** Dairy Goats
- A5** Poultry
- A6** Miniture Goats
- A7** Horse Events

Exhibits/Displays

- B1** Utes
 - Farm Produce
 - Fruit and Vegetables
 - Cookery
 - Horticulture
- B2** Needlework
- B3** Handicraft
- B4** Education
 - Fine Arts
 - Photography
- B5** Lego

Food and Drink

- C1** Marburg State School Canteen
- C2** Food Vans
- C3** Food Vans
- C4** Marburg Show Society Canteen & Bar
- C5** Marburg Show Society BBQ
- C6** Food Vans

Rides and Attractions

- T** Ride Tickets
- ★** Free Train Ride Stop
 - Dodgers
 - Jumping Castle
 - Cannibal Pots
 - Shooting Gallery
 - Laughing Clowns
 - Catch a Duck
- D1** Face Painting
- D2** Interactive Oceans
- D3** Kids Entertainment Area
- D4** Entertainment Area
- D5** Animal Farm
- D6** Centre Ring Entertainment
- D7** 9D Virtual Reality Simulator

Points of Interest

- E1** Show Office
- E2** ATM
- E3** Stage
- E4** Showbags
- E5** Market Stalls
- E6** Market Stalls
- E7** Market Stalls

Key

- Disabled Toilets
- Toilets
- First Aid
- Building
- Sand Arena
- Track
- Road